

# MR-FLEX

FLEXIBLE METAL AND RUBBER COMPENSATORS

## Style 130 Double-Sphere & 131 Single-Sphere Connectors.

### Structure

Item No	Part	Material
1	Body	CR, EPDM, IIR, NBR, CSM, VITON
2	Reinforce	Nylon Cord Fabric
3	Union	Malleable Iron

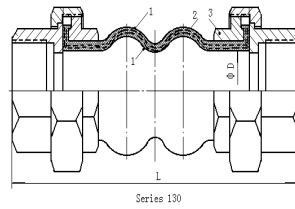

Standard item employs union BSPP, BSPT or NPT thread. Optional extra control cables and mild steel ring between the two spheres.

### Features

- 1, Four way greater movements provide high level of installation flexibility.
- 2, Precision molded of synthetic rubber reinforced with nylon cord.
- 3, Excellent ability to absorb vibration and sound, withstand high pressure
- 4, Withstand chemical corrosion, to resist acid and ozone attack.
- 5, Easy to install, use floating flanges.

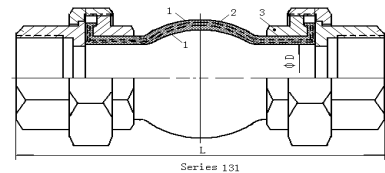

### Specification

#### Style 130 Double Sphere Connectors

Nominal Diameter	Installed Length	Travel mm	Allowable Movement ( mm )				Pressures			
			Neutral Length	Minimum Maximum	Total Compressed	Axial	Axial Extension	Lateral Deflection	Angular Deflection	Positive P.S.I.G. at 80 °C
Inch	mm	mm	Installed	Extended	Compression	ension	ection	ection		mm
1/2"	15	203	186-206	181-209	22	6	22	32	150	660
3/4"	20	203	186-206	181-209	22	6	22	32	150	660
1"	25	203	186-206	181-209	22	6	22	25	150	660
1-1/4"	32	203	186-206	181-209	22	6	22	25	150	660
1-1/2"	40	203	186-206	181-209	22	6	22	20	150	660
2"	50	203	186-206	181-209	22	6	22	15	150	660
2-1/2"	65	240	224-244	218-246	22	6	22	12	150	660
3"	80	240	224-244	218-246	22	6	22	10	150	660

#### Style 131 Single Sphere Connectors

Nominal Diameter	Installed Length	Travel mm	Allowable Movement ( mm )				Pressures			
			Neutral Length	Minimum Maximum	Total Compressed	Axial	Axial Extension	Lateral Deflection	Angular Deflection	Positive P.S.I.G. at 80 °C
Inch	mm	mm	Installed	Extended	Compression	ension	ection	ection		mm
1/2"	15	203	186-206	181-209	22	6	22	32	150	660
3/4"	20	203	186-206	181-209	22	6	22	32	150	660
1"	25	203	186-206	181-209	22	6	22	25	150	660
1-1/4"	32	203	186-206	181-209	22	6	22	25	150	660
1-1/2"	40	203	186-206	181-209	22	6	22	20	150	660
2"	50	203	186-206	181-209	22	6	22	15	150	660

### Operation Conditions

Size	Working Pressure	Burst Pressure
1/2" - 2"	16 kg/cm <sup>2</sup>	50 kg/cm <sup>2</sup>
2-1/2" - 3"	10 kg/cm <sup>2</sup>	30 kg/cm <sup>2</sup>

\*: For vacuum applications, please contact sales for professional advice.  
Pressure rating is valid if and only if vacuum ring is utilized.